

### Miniature Metal Bellows Coupling Stainless Steel

with Collet Clamps

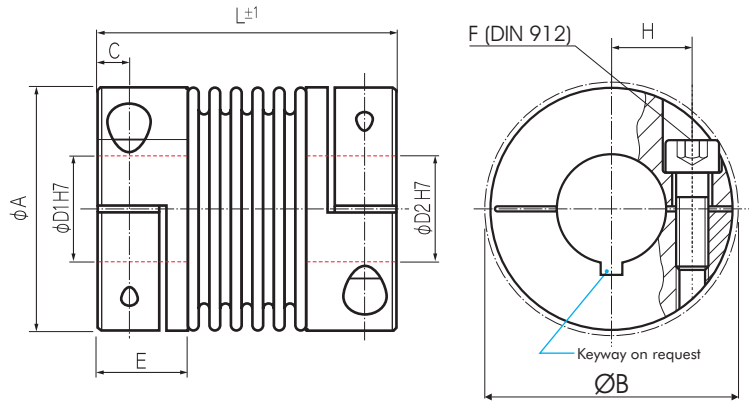

**Order Code: KB 2 / 45 - 55 - 10 - 16 - VA/VAW**

Type / Size

Length L

Ø D1 (H7)

Ø D2 (H7)

Stainless Steel laser-beam-welded  
Stainless Steel glued

VA/VAW	Torque T <sub>KN</sub> (Nm)	Dimensions (mm)								Technical Ratings							
		L Length (±1)	Ø A Outer Ø	D1/D2 Bore Sizes (H7) min ~ max	H	C	Ø B Max Ø	E Hub- length	F Screw (DIN 912) T <sub>A</sub> (Nm)	Mass (g)	Moment of Inertia J (g cm <sup>2</sup> )	Spring Stiffness			Misalignment		
												torsial C <sub>T</sub> (Nm/rad)	radial C <sub>R</sub> (N/mm)	axial C <sub>A</sub> (N/mm)	radial ΔK <sub>r</sub> (mm)	axial ΔK <sub>a</sub> (mm)	angular ΔK <sub>w</sub> (°)
KB2/1	0.1	25	10	1-4	3.4	2	11	7	M1.6	7	1	65	10	14	0.12	0.2	1.2
									0.1								
KB2/5	0.5	21	15.5	3-7	5.2	2.5	17.5	8	M2	18	5.9	260	43	13	0.1	0.2	1
		25							18	6.2	200	18	10	0.15	0.3	1.5	
		28							19	6.6	160	9	8	0.2	0.4	2	
KB2/10	1	23	15.5	3-7	5.2	2.5	17.5	8	M2	19	6.8	510	74	27	0.1	0.2	1
		26							20	7.5	380	31	20	0.15	0.3	1.5	
		31							21	8.1	310	16	16	0.2	0.4	2	
KB2/15	1.5	26	20	3-10	7	3	21	9	M2.5	36	18	750	59	15	0.1	0.3	1.5
		31							38	21	700	20	9	0.15	0.4	2	
KB2/20	2	32	25	3-12.7	9	3.5	18	11	M3	70	53	1500	67	12	0.15	0.3	1.5
		38							73	60	1300	21	11	0.2	0.4	1.5	
		42							75	64	1050	11	9	0.25	0.5	2	
		47							92	73	1050	11	9	0.25	0.5	2	
KB2/45	4.5	41	32.5	6-16	11.5	5	34	14	M4	133	220	6500	168	32	0.1	0.3	1.5
		48							15.5	166	240	6500	168	32	0.1	0.3	1.5
		50							14	139	246	4200	41	20	0.2	0.5	2
		55							15.5	172	266	4200	41	20	0.2	0.5	2
KB2/100	10	48	40.5	6-22	15.5	5	41.5	14	M4	244	513	8100	120	27	0.15	0.4	1.5
		54							17	300	600	8100	120	27	0.15	0.4	1.5
		57							14	261	638	6800	29	17	0.3	0.6	2
		64							17	317	726	6800	29	17	0.3	0.6	2

- Material: Bellows - Stainless Steel  
Hubs - Stainless Steel
- Temperature Range: VA -30° ~ 120° (glued)  
VAW -30° ~ 250° (laser-beam-welded)

- Version VA: Stainless Steel glued  
Version VAW: Stainless Steel laser-beam-welded
- Keyway acc. DIN 6885 optional