

Bellows Couplings in Stainless Steel

with Collet Clamps

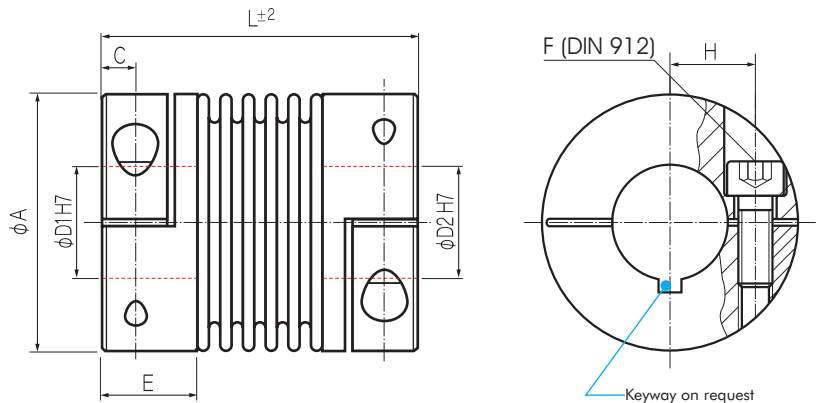

Order Code: KB 4 / 60 - 89 - 12 - 32 - VA/VAW

Type / Size

Length

Ø D1
(H7)

Ø D2
(H7)

Stainless Steel laserwelded
Stainless Steel glued

| | Torque T _{KN} (Nm) | Dimensions (mm) | | | | | | | Technical Ratings | | | | | | | | |
|---------|-----------------------------------|---------------------|-------------------|-----------------------------|----|-----|------|--|-------------------|---|---|------------------------------------|-----------------------------------|-----------------------------------|----------------------------------|-----------------------------------|---------------------|
| | | L Length (±2) | Ø A Outer Ø | D1/D2 Bore Sizes (H7) | H | C | E | F Screw (DIN 912) T _A (Nm) | Mass (kg) | Moment of Inertia J (g m ²) | Spring Stiffness | | | Misalignment | | | max Speed rpm |
| | | | | | | | | | | | torsional C _T 10 ³ (Nm/rad) | radial C _R (N/mm) | axial C _A (N/mm) | radial ΔK _r (mm) | axial ΔK _a (mm) | angular ΔK _w (°) | |
| KB4/18 | 18 | 63 | 45 | 10-25.4 | 17 | 5.5 | 19.5 | M5 | 0.27 | 0.11 | 20 | 205 | 50 | 0.2 | 0.5 | 1.5 | 12800 |
| | | 71 | | | | | | 8 | 0.41 | 0.14 | 15 | 82 | 36 | 0.25 | 0.5 | 2 | 12800 |
| KB4/30 | 30 | 65 | 56 | 10-30 | 20 | 7.5 | 24.5 | M6 | 0.83 | 0.41 | 38 | 720 | 50 | 0.15 | 0.6 | 1.5 | 10300 |
| | | 73 | | | | | | 15 | 0.89 | 0.44 | 28 | 225 | 28 | 0.25 | 1 | 2 | 10300 |
| KB4/60 | 60 | 79 | 66 | 12-32 | 23 | 10 | 29 | M8 | 1.4 | 0.91 | 75 | 1150 | 90 | 0.15 | 0.6 | 1.5 | 8700 |
| | | 89 | | | | | | 40 | 1.7 | 1.00 | 50 | 340 | 50 | 0.25 | 1 | 2 | 8700 |
| KB4/80 | 80 | 91 | 82 | 14-42 | 28 | 11 | 33.5 | M10 | 2.3 | 2 | 128 | 1200 | 80 | 0.2 | 0.5 | 1.5 | 6900 |
| | | 102 | | | | | | 72 | 2.4 | 2.1 | 75 | 400 | 50 | 0.25 | 0.8 | 2 | 6900 |
| KB4/150 | 150 | 91 | 82 | 19-42 | 28 | 11 | 33.5 | M10 | 2.3 | 2 | 155 | 2020 | 145 | 0.2 | 0.5 | 1.5 | 6900 |
| | | 102 | | | | | | 84 | 2.4 | 2.1 | 105 | 595 | 85 | 0.25 | 0.5 | 2 | 6900 |
| KB4/200 | 200 | 101 | 90 | 22-45 | 31 | 13 | 38 | M12 | 2.6 | 3.3 | 175 | 2500 | 145 | 0.2 | 0.5 | 1.5 | 6400 |
| | | 113 | | | | | | 125 | 2.7 | 3.5 | 120 | 460 | 82 | 0.25 | 0.8 | 2 | 6400 |
| KB4/300 | 300 | 105 | 110 | 30-60 | 40 | 13 | 38 | M12 | 3.6 | 7.3 | 502 | 6300 | 280 | 0.2 | 0.5 | 1.5 | 6000 |
| | | 116 | | | | | | 145 | 3.7 | 7.5 | 285 | 1400 | 145 | 0.25 | 0.8 | 2 | 6000 |
| KB4/500 | 500 | 112 | 122 | 35-70 | 42 | 15 | 42 | M12 | 5.1 | 12.4 | 690 | 7790 | 100 | 0.2 | 0.5 | 1.5 | 5000 |
| | | 123 | | | | | | 145 | 5.2 | 12.7 | 320 | 970 | 85 | 0.25 | 1 | 2 | 5000 |

Material: Bellows - high Tensile Stainless Steel
Hubs - Stainless Steel

Temperature Range: VA -30° ~ 120° (glued)
VAW -30° ~ 250° (laser-beam-welded)

Version VA: Stainless Steel glued
Version VAW: Stainless Steel laser-beam-welded

Hubs: Keyway acc. DIN 6885 optional